

Series 735

SERIES 735



Design Features

Due to some major technology enhancements, the 735 encoder is now available in four resolution ranges, from 0001 PPR through to 30,000 PPR. With models 735/2 through 735/4, which use advanced circuitry, it is now possible to provide selected resolutions up to 30,000 PPR. Please note, that within the higher resolution bands, the edge separation specifications reduce minimally, to 50°. A stainless steel version is available at a modest surcharge. This version is designed for hostile environments or food applications. It is protected to IP66, and is configured with 2 metres of flying lead. Please call the sales office for details.

Specifications

Input Voltage range	5/24V (see output circuits)	Starting torque.....	0.002 Nm (0.02 with seal)
Regulation, for 5V operation	5%, with 2% maximum ripple	Radial loading.....	80 N operating
Current consumption	80mA typical	Axial loading.....	60 N operating
Output circuits	See Ordering Information	Moment of inertia.....	70 g/cm
Frequency response	200 KHz (735/1 - 50KHz)	Acceleration.....	10 ⁵ radians/sec ²
Symmetry	180° electrical ±5% (9°e)	Weight.....	0.5 kg
Quadrature Phasing	90° electrical ±10% (9°e)	Housing.....	Aluminum w/protective finish
Minimum edge separation	72° electrical	Mounting.....	Servo flange or square flange
Reference marker pulse	Gated (A • B • Z = F)	Operating temperature.....	-10°C to +70°C
Rise time	Less than 1 microsecond	High temperature.....	-10°C to +100°C
Accuracy (cycle to cycle)	±0.017° or 1 Arc/Min	Storage temperature.....	-30°C to +85°C
LED life	100,000 hrs typical	Humidity.....	98% RHNC
Pulses per revolution	See Ordering Information	Vibration.....	10 G's @ 58 to 500 Hz
Max shaft speed	6,000 rpm continuous	Shock.....	50 G's for 11 mSec
Shaft sizes and types	See Ordering Information	Protection.....	IP50 standard
Shaft tolerance	g6, sliding fit for H7		IP64 w/seal (S30)
Bearings	ABEC 3		IP66 w/seal (S36)

Ordering Information

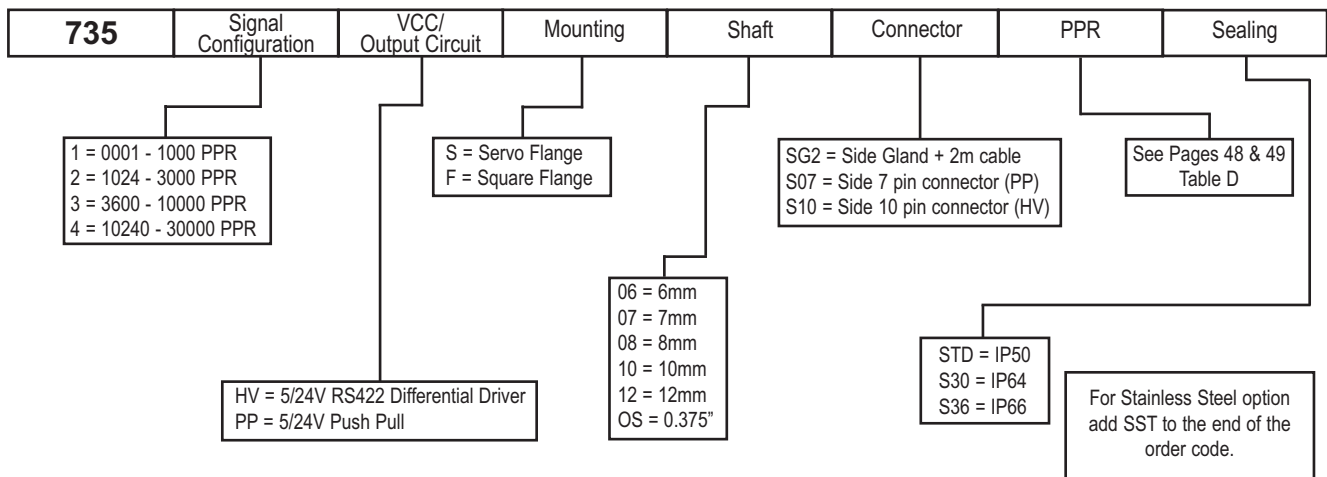



Output Circuits

HV
Universal
Differential
Line Driver

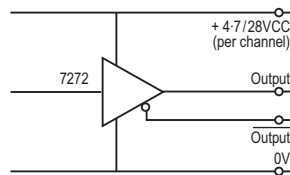

PP
Push-Pull

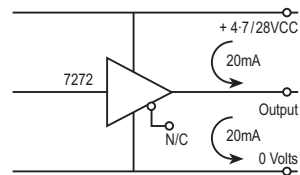

Dimensions

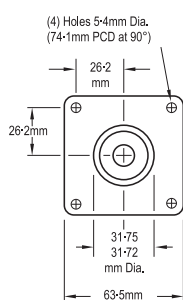

Flange Mount

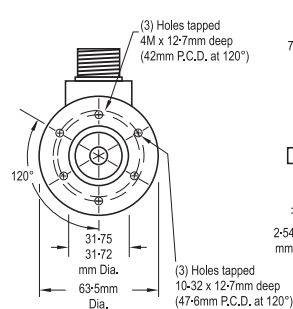
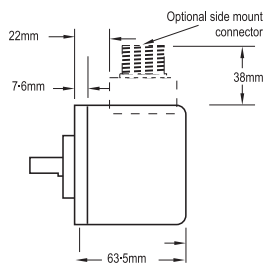

Servo Mount

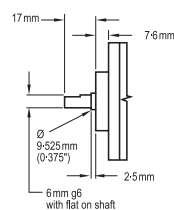
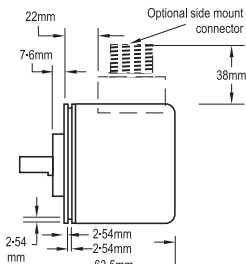

6mm Shaft

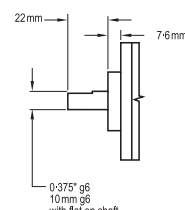

0.375" and 10mm Shafts

